

# Heavy Duty

## Types 25|30|50|66|80

TÜV/GS and DGUV Test-certified  
cable holders for

- Lighting fixtures
- Fair booth Construction
- Constructions sites
- Rigging



REUTLINGER<sup>®</sup>  
systematic suspension



# The world's only TÜV/GS-certified cable holders



The TÜV/GS- and DGUV Test-Certificate  
A safety guarantee from REUTLINGER.

## The only TÜV/GS-certified holders

The German TÜV is internationally renowned as a rigorous testing institution and is highly trusted by producers and consumers – especially for technical products.

The highest and most comprehensive level of TÜV testing is GS certification, denoting safe equipment and recognisable by the well-known blue sticker.

REUTLINGER is the world's only manufacturer of cable suspension systems that has succeeded in complying with the demands of GS certification with every product line: Our promise of safety confirmed by the TÜV\*.

### Certified by DGUV Test

Additionally holders Type 50 SV II, Type 66 und Type 80 SV II are certified by DGUV Test, also see page 16.



## TÜV/GS-Certification

The following REUTLINGER holders have been TÜV/GS-certified

### Holders Type 25

Certificate no.  
TÜV/GS Z1A 10 03 14229 035

### Holders Type 30

Certificate no.  
TÜV/GS Z1A 12 03 14229 040



## TÜV/GS- and DGUV Test-certification

The following holders have been certified by TÜV/GS und DGUV Test:

### Holders Type 50 SV II

Certificate no.  
TÜV/GS Z1A 13 07 14229 044  
DGUV Test OA 1351010

### Holders Type 66

Certificate no.  
TÜV/GS Z1A 12 03 14229 041  
DGUV Test OA 1351010

### Holders Type 80 SV II

Certificate no.  
TÜV/GS Z1A 13 07 14229 045  
DGUV Test OA 1351010

\* The German TÜV is a semi-governmental technical supervisory agency



**Loadable & Flexible**

Even when suspending heavy loads, REUTLINGER holders are infinitely adjustable up and down the cable without tools.

Unscrew safety cap, suppress plunger, slide the holder, release the plunger and screw down the safety cap – that’s it.

**REUTLINGER · Specialists for cable attachments and suspension 04**

**Technical Information 05**

**Holder type 25 06**

- Central cable exit or lateral cable exit ..... 06
- Lateral cable exit, with exterior or interior thread, Special versions ..... 07

**Holder type 25 08**

- Central cable exit or lateral cable exit, knurled, with safety cap ..... 08
- Central cable exit with safety cap, Special versions ..... 09

**Holder type 30 10**

- Central cable exit, with and without knurl, with safety cap ..... 10
- Lateral cable exit, knurled, with safety cap ..... 11
- Special versions, with safety cap ..... 12

**Holder type 30 [black zinc-plated] 14**

- Central cable exit or lateral cable exit, knurled or without knurl, with safety cap ..... 14
- Special versions, with safety cap ..... 15

**Holder type 50 SV II 17**

- Central cable exit, with safety cap ..... 17

**Holder type 50 SV II [black zinc-plated] 18**

- Central or lateral cable exit, with safety cap ..... 18

**Holder type 66 [black zinc-plated] 20**

- Central or lateral cable exit, with safety cap ..... 20

**Holder type 80 SV II [black zinc-plated] 22**

- Central or lateral cable exit, with safety cap ..... 22

**Cables & Accessories 24**

- Cables ..... 24
- Swaged fittings & cable ends ..... 25
- Ceiling attachments ..... 26
- Tensioning systems ..... 27

**Contact 28**

## REUTLINGER - Specialists for cable attachments and suspension



### From a traditional workshop into a global high-tech company

„Technology should help us reach our goals. Therefore REUTLINGER constantly strives for logic and simplicity in all our products. Every detail must be functional and each function must make sense.“

For REUTLINGER this is not just a guiding principle, but an obligation. In the year 1864 W. B. Reutlinger began with the industrial manufacturing and processing of hemp rope and mechanical steel cable.

Wolf Reutlinger, who has led the company since 1987, continued this tradition of craftsmanship while initiating innovative processes which opened up new applications and markets.

### More than meets the eye

The use of REUTLINGER fastening attachments always results in permanent connections. This is the effect guaranteed by the self-locking mechanisms at the heart of our attachments. The elements devised specifically for this purpose are based on the following principle: the heavier the load – the greater the clamping force. For safe working loads (SWL) up to 330 kg.

By continually expanding the range of our products we were able to dominate the world market for suspended lighting fixtures within a few years. Today we are proud to count virtually all producers of high-quality lighting fixtures – as well as the automobile industry, sign- and shelf-manufacturers, galleries and museums – among our regular customers.

### Customer demands – a constant incentive to innovate

Highly qualified employees, the use of modern CAD systems and fully automated production facilities allow us to consistently turn out innovative products of unvarying high quality. We individually develop and manufacture our products in close cooperation with our customers. We put all our know-how at the disposal of our customers – from initial planning to detailed construction and manufacture right up to final installation.

### »Improve what is good, change what is ineffective«

Keeping an eye on quality and costs reflects this thinking – in all of our products. We pay special attention to the constant optimising of the following factors:

- increase loadability of the complete system
- reduce size to improve visual adaptability
- increase design variations
- reduce customers' installation time

## Adjusting without tools

First, the knurled cap is unscrewed a few thread turns so the cable can be inserted (see illustration 1).

Once the holder is put in place, the cap is screwed down until firm resistance is felt. This pulls the cable into the cone (see illustration 2).

Vertical readjustment of the holder follows the same procedure (see illustration 3).

Inadvertent unclamping through skewed loading or inattentiveness can no longer result in fallen loads.

We recommend occasional readjustment of the safety cap.

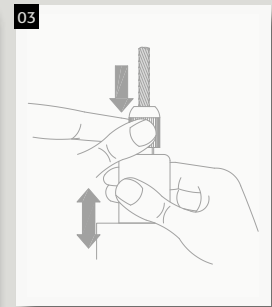
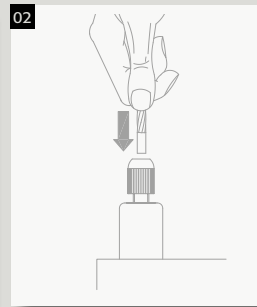
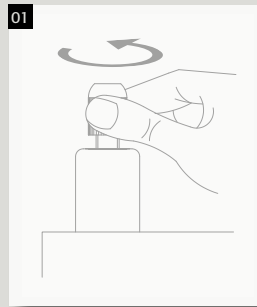

## Safety caps

Safety caps prevent inadvertent release of the clamping mechanism inside the holders. That's why the plunger is threaded. Safety caps are available in various versions.

- Cylindrical safety caps available with cross knurling (see p. 8) or vertical knurling (see p. 10)

- Domed safety caps are available with or without cross- oder vertical knurling

## Working loads & cables

A system's SWL equals 20% of its breaking load.

SWL is increased by 20% when using 6-ball holders.

Cables				Recommended cables & working loads					
ø [mm]	Material	Surface	Construction	Type 25	Type 30	Type 30 S	Typ 50SV II	Type 66	Type 80SV II
1,5	Stainless Steel	Stainless steel	6x7+1SE, 1.570 N/mm <sup>2</sup>	23 kg					
	Steel	zinc-plated silver	6x7+1SE, 2.300 N/mm <sup>2</sup>	24 kg					
1,8	Stainless Steel	Stainless steel	6x7+1SE, 1.570 N/mm <sup>2</sup>	30 kg					
	Steel	zinc-plated silver	6x7+1SE, 2.300 N/mm <sup>2</sup>	42 kg					
2,0	Stainless Steel	Stainless steel	6x7+1SE, 1.570 N/mm <sup>2</sup>	35 kg					
	Steel	zinc-plated silver	6x7+1SE, 2.300 N/mm <sup>2</sup>	56 kg					
2,5	Stainless Steel	Stainless steel	6x7+1SE, 1.570 N/mm <sup>2</sup>	42 kg	50 kg	60 kg			
	Steel	zinc-plated silver	6x7+1SE, 2.300 N/mm <sup>2</sup>	68 kg	70 kg	84 kg			
3,0	Stainless Steel	Stainless steel	6x7+1SE, 1.570 N/mm <sup>2</sup>		70 kg	84 kg			
	Steel	zinc-plated silver	6x7+1SE, 2.300 N/mm <sup>2</sup>		85 kg	102 kg			
4,0	Steel	zinc-plated silver	6x7+1FE, 1.770 N/mm <sup>2</sup>				80 kg		
	Steel	zinc-plated silver	6x19+1FE, 1.770 N/mm <sup>2</sup>				80 kg		
	Steel	zinc-plated black	6x7+1SE, 1.960 N/mm <sup>2</sup>				80 kg		
5,0	Steel	zinc-plated silver	6x7+1FE, 1.770 N/mm <sup>2</sup>				130 kg		
	Steel	zinc-plated silver	6x19+1FE, 1.770 N/mm <sup>2</sup>				130 kg		
	Steel	zinc-plated black	6x7+1SE, 1.960 N/mm <sup>2</sup>				130 kg		
6,0	Steel	zinc-plated silver	6x19+1FE, 1.770 N/mm <sup>2</sup>					190 kg	190 kg
	Steel	zinc-plated silver	6x37+1FE, 1.770 N/mm <sup>2</sup>						190 kg
	Steel	zinc-plated black	6x19+1SE, 1.960 N/mm <sup>2</sup>					190 kg	190 kg
6,35 (1/4")	Steel	zinc-plated silver	6x19+1FE, 1.770 N/mm <sup>2</sup>					210 kg	
	Steel	zinc-plated silver	6x19+1SE, 1.770 N/mm <sup>2</sup>					210 kg	
8,0	Steel	zinc-plated silver	6x19+1FE, 1.770 N/mm <sup>2</sup>						330 kg
	Steel	zinc-plated silver	6x37+1FE, 1.770 N/mm <sup>2</sup>						330 kg
	Steel	zinc-plated black	6x19+1SE, 1.960 N/mm <sup>2</sup>						330 kg

Chart 1: Recommended cables & working loads

## Holder type 25

Cable diameter 1.5 mm to 2.5 mm (all illustrations in original size)

Central cable exit,  
with exterior thread

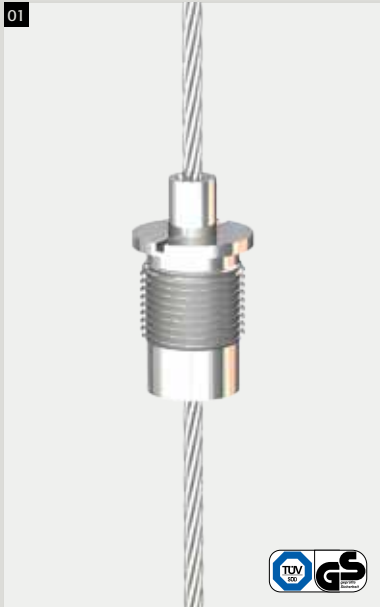

**01**  
Holder type 25  
M13x10A

Collar diameter	15 mm
Length	20 mm
Coupling Thread	M13x1
Thread depth	10 mm
Art. Nr.	193.000.364

Holder type 25  
M16x12A

Collar diameter	18 mm
Length	18 mm
Coupling Thread	M16x1
Thread depth	12 mm
Art. Nr.	193.000.252

### Information

Other versions on demand,  
e.g. with/without knurl,  
with/without safety cap



Central cable exit,  
with safety cap an ring



**02**  
Holder type 25

Diameter	12 mm
Length	32 mm
Thread depth	6 mm
M8 Art. no.	193.000.250
M10x1 Art. no.	193.000.248



**03**  
Holder type 25 V ring

Diameter	15 mm
Length	60 mm
Exterior ring diameter	42.5 mm
Interior ring diameter	27.5 mm
Art. no.	193.003.081

Ceiling Lamp, Model ›AIR‹ by NOSCH



**Lateral cable exit,  
with exterior or interior thread**



**01**  
**Holder type 25 ZW**

Diameter	12 mm
Length	44 mm
Coupling thread	M8/M10x1
Thread depth	7 mm
M8 Art. no.	193.000.220
M10x1 Art. no.	193.000.266



**02**  
**Holder type 25 ZW**

Diameter	12 mm
Length	44 mm
Coupling thread	M6i/M8i/M10x1i
Thread depth	8 mm
M6i Art. no.	193.000.228
M8i Art. no.	193.000.271
M10x1i Art. no.	193.000.272

**Special  
versions**



**03**  
**Y-Holder type 25 ZW  
M6i cross hole 3 mm with  
set screw DIN 915 M6x8**

Diameter	12 mm
Length	44 mm
Coupling thread	M6i
Thread depth	8 mm
Cross hole	3 mm
Art. no.	193.000.765



**04**  
**Holder type 25  
Bo 6 (Gallery holder)**

Dimension	12x12 mm
Length	44,5 mm
Bore diameter	6,2 mm
Art. no.	193.000.294

## Holder type 25

Cable diameter 1.5 mm to 2.5 mm (all illustrations in original size)

Central/Lateral cable exit,  
with exterior thread, knurl  
and safety cap



**01**  
Holder type 25 V m.R.

Diameter	12 mm
Length	32 mm
Coupling thread	M8/M10x1
Thread depth	6 mm
M8 Art. no.	193.000.241
M10x1 Art. no.	193.000.251



**02**  
Holder type 25 V ZW m.R.

Diameter	12 mm
Length	44 mm
Coupling thread	M8/M10x1
Thread depth	7 mm
M8 Art. no.	193.000.263
M10x1 Art. no.	193.000.273

Lateral cable exit,  
with interior thread, knurl  
and safety cap



**03**  
Holder type 25 V ZW m.R.

Diameter	12 mm
Length	44 mm
Coupling thread	M6i/M8i/M10xi
Thread depth	8 mm
M6i Art. no.	193.000.242
M8i Art. no.	193.000.274
M10xi Art. no.	193.000.275



**04**  
Y-Holder type 25 ZW  
M6i m.R. slot 3.0 mm and  
setscrew DIN 915 M6x8

Diameter	12 mm
Length	44 mm
Coupling thread	M6i
Thread depth	8 mm
slot width	3 mm
Art. no.	193.000.288



Central cable exit  
with safety cap  
Special versions



**01**  
**Holder type 25 V**  
**M8, with fork 6x12**

Diameter	12 mm
Length	56 mm
Usable fork depth	12 mm
Inside length fork	20 mm
Fork width	6 mm
Bolt diameter	6 mm
Art. no.	193.000.034



**02**  
**Holder type 25 V**  
**M13x10A**

Collar diameter	15 mm
Length	20 mm
Coupling thread	M13x1
Thread depth	10 mm
Art. no.	193.000.254

**Holder type 25 V**  
**M16x12A**

Collar diameter	15 mm
Length	20 mm
Coupling thread	M16x1
Thread depth	12 mm
Art. no.	193.006.948



**03**  
**Holder type 25 V K**  
**with coupling part M10x1 SW 14**

Diameter	12 mm
Length	26 mm
Coupling thread	M10x1
Wrench size	14 mm
Art. no.	193.000.259

**Information**

Other versions upon request,  
e.g. with/without knurl,  
with/without safety cap



## Holder type 30\*

Cable diameter 2.5 mm to 3.0 mm (all illustrations in original size)

30

### Higher safety through 6 clamping balls

In the »superholder« series, the clamping force is applied by 6 balls (Type SV) instead of 3 balls (Type V).

Their reinforced mechanism increases loadability by 20 %.

### Central cable exit, with exterior thread and safety cap



**01**  
Holder type 30 V  
M8

Diameter	15 mm
Length	37 mm
Connection thread	M8
Thread length	8 mm
Art. no.	193.006.048

### Central cable exit, with exterior thread, knurled and with safety cap



**02**  
Holder type 30 V/SV  
M8 m.R.

Diameter	15 mm
Length	37 mm
Coupling thread	M8
Thread depth	8 mm
Type V, 3 balls	Art no. 193.000.301
Type SV, 6 balls	Art no. 193.000.308

### Holder type 30 V/SV M10 m.R.

as 01, except	
Coupling thread	M10
Thread depth	8 mm
Type V, 3 balls	Art no. 193.000.302
Type SV, 6 balls	Art no. 193.000.326

### Information

Other versions upon request, e.g. with/without knurl, with/without safety cap



\* All holders type 30 are not certified by DGUV Test!



**01**  
Holder type 30 V/SV  
M10x1 m.R.

Diameter	15 mm
Length	37 mm
Coupling thread	M10x1
Thread depth	8 mm
Type V, 3 balls	Art no. 193.000.303
Type SV, 6 balls	Art no. 193.000.325

**Holder type 30 V/SV  
M12 m.R.**

Diameter	15 mm
Length	37 mm
Coupling thread	M12
Thread depth	8 mm
Type V, 3 balls	Art no. 193.000.300
Type SV, 6 balls	Art no. 193.000.305

**Holder type 30 V/SV  
M13x1 m.R.**

Collar diameter	15 mm
Length	37 mm
Coupling thread	M13x1
Thread depth	8 mm
Type V, 3 balls	Art no. 193.000.307
Type SV, 6 balls	Art no. 193.000.328



**Central cable exit,  
with exterior thread, knurled  
and with safety cap**



**02**  
Holder type 30 V/SV ZW  
M6i m.R.

Diameter	15 mm
Length	53 mm
Coupling thread	M6i
Thread depth	8 mm
Type V, 3 balls	Art no. 193.000.310
Type SV, 6 balls	Art no. 193.000.311

**Holder type 30 V/SV ZW  
M8i m.R.**

Diameter	15 mm
Length	53 mm
Coupling thread	M8i
Thread depth	8 mm
Type V, 3 balls	Art no. 193.000.315
Type SV, 6 balls	Art no. 193.000.330



**Special solutions for bevel  
suspensions: ball joint ceiling coupler  
at the ceiling and/or hinged holder  
at the object.**

\* All holders type 30 are not certified by DGUV Test!

## Holder type 30\*

Cable diameter 2.5 mm to 3.0 mm (all illustrations in original size)

30



»Sparkasse Burgelandkreis« Austria  
Chandelier made by SPECTRAL,  
Gesellschaft für Lichttechnik  
Photography by Thomas Dix

### Information

Other versions on demand,  
e.g. with/without knurl,  
with/without safety cap



Central cable exit,  
knurled/without knurl  
and with safety cap



01  
Holder type 30 V/SV  
m.R. with fork 10x20 and  
safety bolt

Diameter	15 mm
Length	81 mm
Usable fork depth	20 mm
Inside length fork	32 mm
Fork width	10 mm
Bolt diameter	10 mm
Type V, 3 balls	Art no. 193.000.290
Type SV, 6 balls	Art no. 193.000.324

\* All holders type 30 are not  
certified by DGUV Test!



**01**  
Holder type 30 V/SV  
ring

Diameter	15 mm
Length	62 mm
Exterior ring diameter	42.5 mm
Interior ring diameter	27.5 mm
Type V, 3 balls	Art no. 193.000.316
Type SV, 6 balls	Art no. 193.000.318



**02**  
Holder type 30 V/SV ZW  
m.R. hinged M8i

Diameter	15 mm
Length	80 mm
Coupling thread	M8i
Thread depth	10 mm
Type V, 3 balls	Art no. 193.000.347
Type SV, 6 balls	Art no. 193.000.346



**03**  
Holder type 30 V/SV  
Design hook

Length	58 mm
Hooks opening	13 mm
Type V, 3 balls	Art no. 193.006.590
Type SV, 6 balls	Art no. 193.006.526

European utility patent  
000 169 594 - 0001+ 0002



\* All holders type 30 are not certified by DGUV Test!

## Holder type 30\*

Cable diameter 2.5 to 3.0 mm (all illustrations in original size)

30

Central cable exit, with exterior thread, without knurl, with safety cap



**01**  
Holder type 30 SV  
M8, black zinc-plated

Diameter	15 mm
Length	37 mm
Coupling thread	M8
Thread length	8 mm
Type SV, 6 balls	Art no. 193.006.107

Central cable exit, with exterior thread, knurled and with safety cap

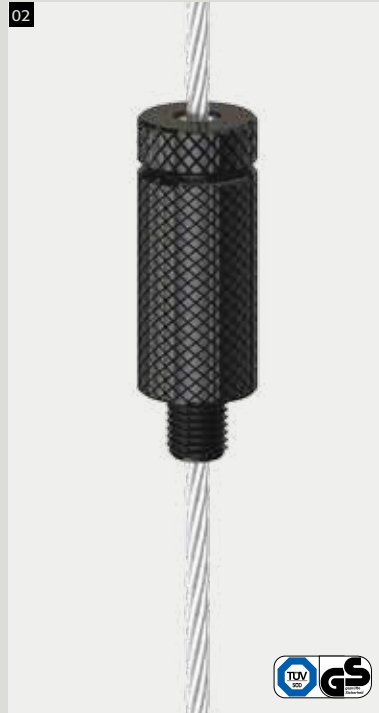

**02**  
Holder type 30 SV  
M8 m.R., black zinc-plated

Diameter	15 mm
Length	37 mm
Coupling thread	M8
Thread length	8 mm
Type SV, 6 balls	Art no. 193.006.114

Alternative coupling threads:

M10	Art. no. 193.006.113
M10x1	Art. no. 193.006.268
M12	Art. no. 193.006.112
M13x1	Art. no. 193.006.111

Lateral cable exit with exterior thread, knurled and with safety cap



**03**  
Holder type Typ 30 SV ZW  
M6i m.R., black zinc-plated

Diameter	15 mm
Length	53 mm
Coupling thread	M6i
Thread depth	8 mm
Type SV, 6 balls	Art no. 193.006.110

Alternative coupling thread:

M8i	Art. no. 193.006.109
-----	----------------------

### Information

Other versions on demand, e.g. with/without knurl, with/without safety cap



\* All holders type 30 are not certified by DGUV Test!

Special versions  
with safety cap



**01**

**Holder type 30 SV  
m.R. with fork 10x20 and  
safety-bolt, black zinc-plated**

Diameter	15 mm
Length	81 mm
Usable fork depth	20 mm
Inside length fork	32 mm
Fork width	10 mm
Bolt diameter	10 mm
Type SV, 6 balls	Art no. 193.006.267



**02**

**Holder type 30 SV  
ring, black zinc-plated**

Diameter	15 mm
Length	62 mm
Exterior ring diameter	42.5 mm
Interior ring diameter	27.5 mm
Type SV, 6 balls	Art no. 193.006.293



**03**

**Holder type 30 SV ZW  
m.R. hinged M8i,  
black zinc-plated**

Diameter	15 mm
Length	80 mm
Coupling thread	M8i
Thread depth	10 mm
Type SV, 6 balls	Art no. 193.006.108

\* All holders type 30 are not certified by DGUV Test!

## Holder type 50 SV II, Type 66 and Type 80 SV II with TÜV GS and DGUV Test

Special holders for rigging  
and fair booth construction

## Type 50 SV II, Type 66 and Type 80 SV II with TÜV GS and DGUV Test



REUTLINGER® grippers type 50 SV II, type 66 and type 80 SV II are not only certified as safe (GS) by the German TÜV, they have also been licensed for use within the scope of standard DGUV Regulation 17 (BGV C1).

The DGUV Test certificate authorises these grippers for use within the scope of the accident prevention regulations issued by the German employers' liability insurance associations in respect of staging and production facilities.

The test seal of the DGUV is conferred only after extensive examining of all load applications. Further testing simulated most anticipated mis-applications. REUTLINGER® gripper ranges 50 SV II, 66 SV II and 80 SV II are the only load-bearing devices certified by the DGUV for use in mobile production facilities.

More information be found  
in our Folder "Event  
Technology"!





Central cable exit  
and safety cap



**01**  
**Holder type 50 SV II**  
**M12, nickel-plated**

Diameter	25 mm
Length	51 mm
Coupling thread	M12
Thread length	18 mm
Art. no.	193.006.898
DGUV certificate no.	OA 1351010



**02**  
**Holder type 50 SV II**  
**Integral ring, nickel-plated**

Diameter	25 mm
Length	85 mm
Exterior ring diameter	54 mm
Interior ring diameter	30 mm
Art. no.	193.006.899
DGUV certificate no.	OA 1351010



**03**  
**Holder type 50 SV II**  
**with fork 14x28 and safety bolt,**  
**nickel-plated**

Diameter	25 mm
Length	107 mm
Usable fork depth	28 mm
Inside length fork	41 mm
Fork width	14 mm
Bolt diameter	14 mm
Art. no.	193.006.901
DGUV certificate no.	OA 1351010



## Holder type 50 SV II

Cable diameter 4.0 to 5.0 mm (all illustrations are scaled)

Central cable exit  
with safety cap

50

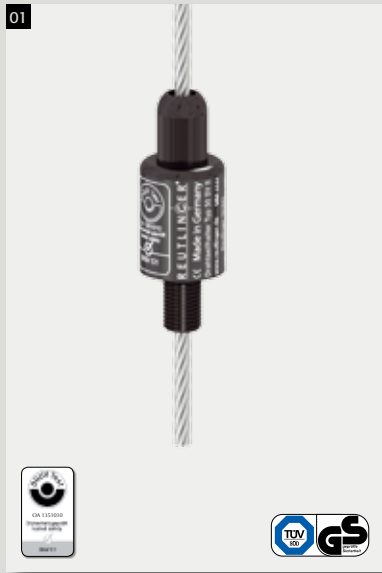

**01**  
Holder type 50 SV II  
M12, black zinc-plated

Diameter	25 mm
Length	51 mm
Coupling thread	M12
Thread depth	18 mm
Art. no.	193.005.021
DGUV certificate no.	OA 1351010

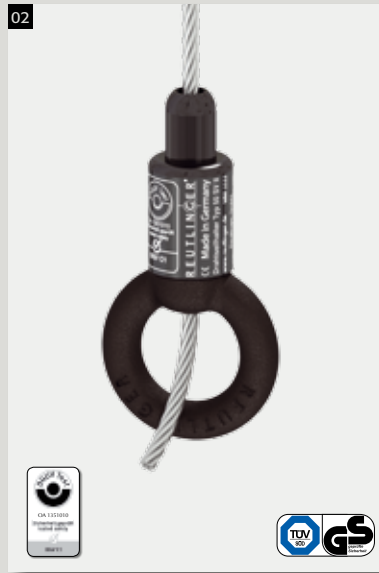

**02**  
Holder type 50 SV II  
Integral ring, black zinc-plated

Diameter	25 mm
Length	85 mm
Exterior ring diameter	54 mm
Interior ring diameter	30 mm
Art. no.	193.005.033
DGUV certificate no.	OA 1351010



Holder type 50 SV II  
Integral ring (original size)



**Information**



Upon request, holders type 50 are also available with nickel-plated surface, please also see p. 17.

**Information**



Cables are available with different diameters also in black colour! Please ask us.

Lateral cable exit  
with safety cap



**01**

**Holder type 50 SV II ZW  
M12i, black zinc-plated**

Diameter	25 mm
Length	72,5 mm
Coupling thread	M12i
Thread depth	10 mm
Art. No.	193.005.025
DGUV certificate no.	OA 1351010

**02**

**Holder type 50 SV II ZW  
with ring, black zinc-plated**

Diameter	25 mm
Length	125 mm
Exterior ring diameter	54 mm
Interior ring diameter	30 mm
Art. no.	193.005.026
DGUV certificate no.	OA 1351010

**03**

**Holder type 50 SV II ZW  
with fork 14x28 and safety-bolt,  
black zinc-plated**

Diameter	25 mm
Length	145 mm
Usable fork depth	28 mm
Inside length fork	41 mm
Fork width	14 mm
Bolt diameter	14 mm
Art. No.	193.005.027
DGUV certificate no.	OA 1351010

**04**

**Holder type 50 SV II ZW  
with Doughty Coupler T58081,  
black zinc-plated**

Diameter	25 mm
Length	130 mm
For tube diameter	45 - 50 mm
Art. No.	193.005.040
DGUV certificate no.	OA 1351010

## Holder type 66

Cable diameter 6.0 mm and 1/4" cables (all illustrations are scaled)

Central cable exit  
with safety cap

66



**01**  
Holder type 66  
M16, black zinc-plated

Diameter	34 mm
Length	68 mm
Coupling thread	M16
Thread length	20 mm
Art. no.	193.007.700
DGUV certificate no.	OA 1351010

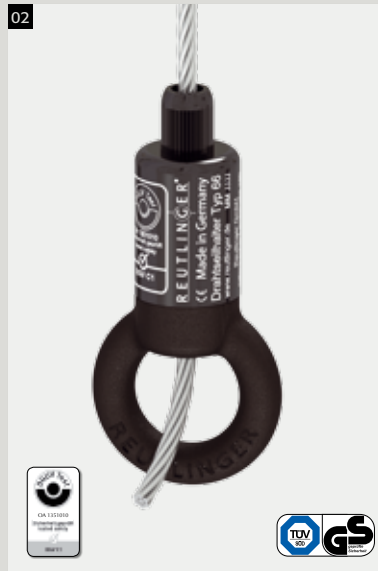

**02**  
Holder type 66  
Integral ring, black zinc-plated

Diameter	34 mm
Length	110 mm
Exterior ring diameter	63 mm
Interior ring diameter	35 mm
Art. no.	193.007.701
DGUV certificate no.	OA 1351010



Holder type 66 Integral ring  
(original size)



**Information**



Holders type 66 are also available with nickel-plated surface (from 500 pcs).  
Delivery time upon request.

**Information**



Cables are available with different diameters also in black colour!  
Please ask us.

Lateral cable exit  
with safety cap



**01**  
**Holder type 66 ZW**  
**M16i, black zinc-plated**

Diameter	34 mm
Length	96 mm
Coupling thread	M16i
Thread depth	12 mm
Art. no.	193.007.702
DGUV certificate no.	OA 1351010

**02**  
**Holder type 66 ZW**  
**with ring, black zinc-plated**

Diameter	34 mm
Length	160 mm
Exterior ring diameter	63 mm
Interior ring diameter	35 mm
Art. no.	193.007.709
DGUV certificate no.	OA 1351010

**03**  
**Holder type 66 ZW**  
**Fork 16x32 with safety-bolt, black zinc-plated**

Diameter	34 mm
Length	176 mm
Usable fork depth	32 mm
Inside length fork	51 mm
Fork width	16 mm
Bolt diameter	16 mm
Art. no.	193.007.705
DGUV certificate no.	OA 1351010

**04**  
**Holder type 66 ZW**  
**with DOUGHTY® Coupler T58101, black zinc-plated**

Diameter	34 mm
Length	160 mm
For tube diameter	48 - 51 mm
Art. no.	193.007.704
DGUV certificate no.	OA 1351010

## Holder type 80 SV II

Cable diameter 6.0 mm to 8.0 mm (all illustrations scaled)

Central cable exit  
with safety cap



**01**  
Holder type 80 SV II  
M20, black zinc-plated

Diameter	40 mm
Length	88 mm
Coupling thread	M20
Thread length	29 mm
Art. no.	193.009.003
DGUV certificate no.	OA 1351010

**02**  
Holder type 80 SV II  
Integral ring, black zinc-plated

Diameter	40 mm
Length	128 mm
Exterior ring diameter	72 mm
Interior ring diameter	40 mm
Art. no.	193.009.011
DGUV certificate no.	OA 1351010



**Information**



Holders type 80 SV II are also available with nickel-plated surface (from 500 pcs). Delivery time upon request.

**Information**

Cables are available with different diameters also in black colour! Please ask us.

Holder type 80 SV II  
Integral ring (original size)

Lateral cable exit  
with safety cap



**01**  
**Holder type 80 SV II ZW**  
**M12i, black zinc-plated**

Diameter	40 mm
Length	110 mm
Coupling thread	M12i
Thread depth	20 mm
Art. no.	193.009.008
DGUV certificate no.	OA 1351010

**02**  
**Holder type 80 SV II ZW**  
**with ring, black zinc-plated**

Diameter	40 mm
Length	181 mm
Exterior ring diameter	72 mm
Interior ring diameter	40 mm
Art. no.	193.009.015
DGUV certificate no.	OA 1351010

**03**  
**Holder type 80 SV II ZW**  
**Fork 20x40 with safety-bolt,**  
**black zinc-plated**

Diameter	40 mm
Length	215 mm
Usable fork depth	40 mm
Inside length fork	65 mm
Fork width	20 mm
Bolt diameter	20 mm
Art. no.	193.009.023
DGUV certificate no.	OA 1351010

**04**  
**Holder type 80 SV II ZW**  
**with DOUGHTY® Coupler T57010,**  
**black zinc-plated**

Diameter	40 mm
Length	195 mm
For tube diameter	48 - 50 mm
Art. no.	193.009.009
DGUV certificate no.	OA 1351010

# Cables

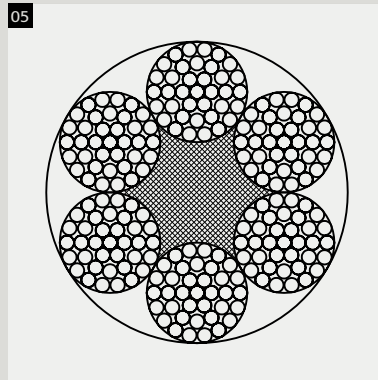
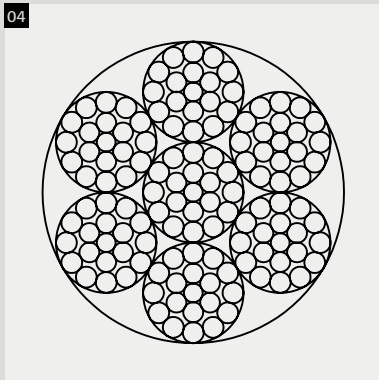
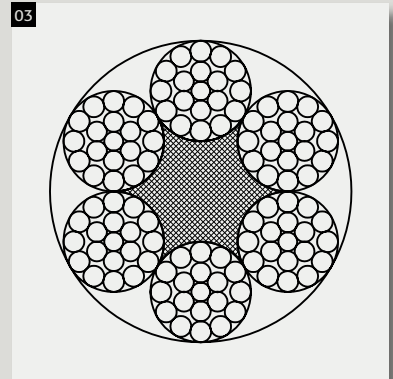
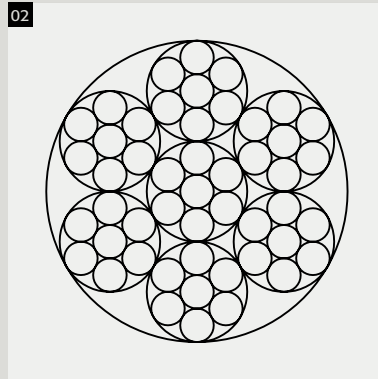
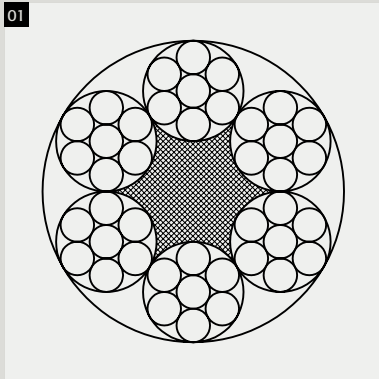

- 01 DIN EN 12385-4 6x7+1FE
- 02 DIN EN 12385-4 6x7+1SE
- 03 DIN EN 12385-4 6x19+1FE
- 04 DIN EN 12385-4 6x19+1SE
- 05 DIN EN 12385-4 6x37+1FE

**Please note:**

Cables must not be greased or oiled!

## 1. Materials + surfaces

Cables are available in two degrees of durability

- 1.1 galvanised steel for normal interior use
- 1.2 stainless steel for exterior use and decorative requirements

## 2. Specific cable strength

Along with the standard-strength cables with 1570 N/mm<sup>2</sup>, we also offer high-tensile strength cables with up to 2300 N/mm<sup>2</sup>. With these you get a higher system strength with the same cable diameter.

## 3. Cable constructions

You can choose between different cable constructions. Please note:

- 3.1 cables with steel core have a higher strength than those with a fibre core but they are less flexible.
- 3.2 Cables with many wires such as 6x37 are more flexible than cables with less wires, as in 7x7 cables.
- 3.3. Swaged-on threaded bolts require cables with steel cores.
- 3.4. Cables running on pulleys should have fibre cores.

## 4. Cable diameter

REUTLINGER offers holders suitable for cables from 1.5 mm to 8.0 mm diameter.

## 5. Using other cables

REUTLINGER cables are free of tension, stress-free, not twisted and cut-proof. When using other cables, take care that cutting does not untwist the cable, because it is possible that they will not fit into the holder after they have been tinned.

## 6. Customised solutions

Let us help you choose the best solution among our variety of cable ends.



## Swaged fittings & cable ends

Upon request cables with various cable ends custom-made to fit individual suspensions (length; materials; diameter).



01	02	03	04	05	06
<b>Loop</b>	<b>Loop &amp; Thimble</b>	<b>Threaded End</b>	<b>Forged Eyelet</b>	<b>Cylindrical sleeve</b>	<b>Zinc-plated ends</b>
Cables available see chart Dimensions according to drawing	Cables available see chart Dimensions according to drawing	Cables available see chart Dimensions according to drawing	Cables available see chart for bolt- $\varnothing$ up to 8 mm	Cables available see chart sleeve- $\varnothing$ 9 mm, sleeve length 11 mm	Cable ends zinc-plated, Cables available see chart

Cables				Cable ends					
$\varnothing$ [mm]	Material	Surface	Construction	01	02	03	04	05	06
1,5	Stainless steel	Stainless steel	6x7+1SE, 1.570 N/mm <sup>2</sup>	●	●	●	●	●	●
	Steel	Silver zinc-plated	6x7+1SE, 2.300 N/mm <sup>2</sup>	●	●	●	●	●	●
1,8	Stainless steel	Stainless steel	6x7+1SE, 1.570 N/mm <sup>2</sup>	●	●	●	●	●	●
	Steel	Silver zinc-plated	6x7+1SE, 2.300 N/mm <sup>2</sup>	●	●	●	●	●	●
2,0	Stainless steel	Stainless steel	6x7+1SE, 1.570 N/mm <sup>2</sup>	●	●	●	●	●	●
	Steel	Silver zinc-plated	6x7+1SE, 2.300 N/mm <sup>2</sup>	●	●	●	●	●	●
2,5	Stainless steel	Stainless steel	6x7+1SE, 1.570 N/mm <sup>2</sup>	●	●	●	●	●	●
	Steel	Silver zinc-plated	6x7+1SE, 2.300 N/mm <sup>2</sup>	●	●	●	●	●	●
3,0	Stainless steel	Stainless steel	6x7+1SE, 1.570 N/mm <sup>2</sup>	●	●	●	●	●	●
	Steel	Silver zinc-plated	6x7+1SE, 2.300 N/mm <sup>2</sup>	●	●	●	●	●	●
4,0	Steel	Silver zinc-plated	6x7+1FE, 1.770 N/mm <sup>2</sup>	●	○	●	●	●	○
	Steel	Silver zinc-plated	6x7+1FE, 1.770 N/mm <sup>2</sup>	●	○	●	●	●	○
	Steel	Black zinc-plated	6x7+1SE, 1.960 N/mm <sup>2</sup>	●	○	●	●	●	○
5,0	Steel	Silver zinc-plated	6x7+1FE, 1.770 N/mm <sup>2</sup>	●	○	●	●	●	○
	Steel	Silver zinc-plated	6x19+1FE, 1.770 N/mm <sup>2</sup>	●	○	●	●	●	○
	Steel	Black zinc-plated	6x7+1SE, 1.960 N/mm <sup>2</sup>	●	○	●	●	●	○
6,0	Steel	Silver zinc-plated	6x19+1FE, 1.770 N/mm <sup>2</sup>	●	○	●	●	●	○
	Steel	Silver zinc-plated	6x37+1FE, 1.770 N/mm <sup>2</sup>	●	○	●	●	●	○
	Steel	Black zinc-plated	6x19+1SE, 1.960 N/mm <sup>2</sup>	●	○	●	●	●	○
8,0	Steel	Silver zinc-plated	6x19+1FE, 1.770 N/mm <sup>2</sup>	●	○	●	●	●	○
	Steel	Silver zinc-plated	6x37+1FE, 1.770 N/mm <sup>2</sup>	●	○	●	●	●	○

Chart 2: Cables with cable ends ● available; ○ only these swaged fittings and cable ends are permitted for use within the scope of DGUV Test! ● upon request

## Ceiling attachments [for cable diameter 1.5 to 3.0 mm]

### Ceiling attachments

Combine ceiling attachments and screw caps for a loadable ceiling suspension.

Various solutions upon request.



**01**  
**Ceiling attachment  
M13x1 M6i**

Flange diameter	20 mm
Diameter	16 mm
Length	21 mm
Coupling thread	M13x1
Art. no.	029.006.003

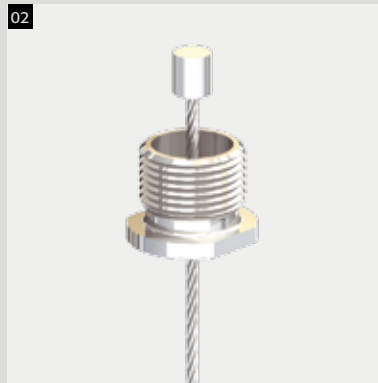

**02**  
**Screw-cap M13x1  
with bore 3,5 mm, SW 14**

Flange diameter	16 mm
Diameter	12 mm
Thread depth	10 mm
Coupling thread	M13x1
Art. no.	029.006.016

**Screw-cap M13x1  
with bore 2,4 mm SW 14**

Flange diameter	16 mm
Diameter	12 mm
Thread depth	10 mm
Coupling thread	M13x1
Art. no.	029.006.002

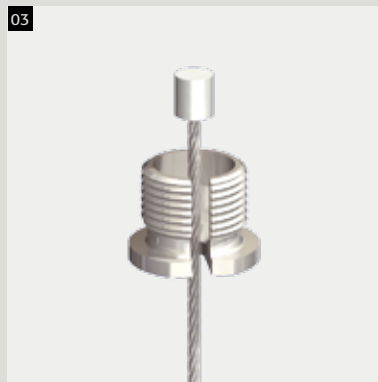

**03**  
**Screw-cap M13x1 ›Quick‹  
with slit 2,4 mm, SW 14**

Flange diameter	16 mm
Diameter	12 mm
Thread depth	10 mm
Coupling thread	M13x1
Art. no.	029.006.055



**04**  
**Combination of  
Ceiling attachment M13x1 M6i  
and screw-cap M13x1 with  
bore 3,5 mm**

Length	22 mm
Art. no.	193.005.206

For details and further dimensions please see article [01](#) and [02](#) !

## Tensioning systems [Type 25 and Type 30]

### Tensioning systems

Tensioners allow you to create strong tensioning systems or vertical installations between floor and ceiling, for example. Tensioning solutions are ideal for the suspensions of displays and other elements.

Further solutions upon request.



#### Information

Tensioning systems using article **01** or **02** can be implemented with two tensioners each (top/bottom) or with a ceiling attachment, e.g. article **04** presented on page 26 (please see the image above).

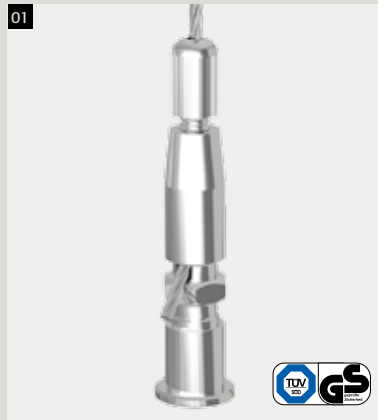

#### **01** Tensioner type 25 V ZW with left-hand/right-hand thread

Applicable with cables  $\varnothing$  1.5 mm to 2.5 mm

Collar diameter	16 mm
Diameter	12 mm
Width across flats	12 mm
Length (screwed)	46 mm
Art. no.	193.006.002



#### **02** Tensioner type 30 SV with big fastening plate

Applicable with cables  $\varnothing$  2.5 mm to 3.0 mm

Attachment plate diameter	40 mm
Diameter	15 mm
Length (screwed)	77 mm
Art. no.	193.000.352





Please request  
the following catalogues:

**Mini**

Holders & Accessories  
Type 10, 12

**Standard**

Holders & Accessories  
Type 15, 18, 20

**Shop | Display**

Presentation and Shelving  
Systems for Retail Applications

**Gallery**

Suspension Systems for Galleries  
and Exhibits

**Rigging & Event Technology**

Holders and Accessories  
Type 50 SV II, Type 66 and  
Type 80 SV II

Have we gotten you interested?  
Do you have questions concerning  
technical details? Please give us a  
call!

**Sales & Consultations  
Germany (D-A-CH)**

Andreas Mixa  
+49 (0) 69 965228-37  
a.mixa@reutlinger.de

Hans-J. Arendt  
+49 (0) 69 965228-16  
hj.arendt@reutlinger.de

Miriam Ansorg-Riedling  
+49 (0) 69 965228-70  
m.riedling@reutlinger.de

**Sales & Consultations  
International**

Silvia Kopka  
+49 (0) 69 965228-12  
s.kopka@reutlinger.de

Stefanie Händler  
+49 (0) 69 965228-18  
s.haendler@reutlinger.de

Ana Maria Ruiz  
+49 (0) 69 965228-47  
am.ruiz@reutlinger.de

**Reutlinger GmbH**

Offenbacher Landstr. 190  
60599 Frankfurt  
Germany

Phone +49 (0) 69 965228-0  
Telefax +49 (0) 69 965228-30

E-Mail info@reutlinger.de  
Internet www.reutlinger.de

**Managing Director**

Dipl. Ing. Wolf Reutlinger

HRB Frankfurt 33321  
USt-ID DE 114 209 718